

Universal Flange

High Watt Density



### UNIVERSAL FLANGE ELEMENTS High Watt Density

Installs with 4-bolts, flange is recessed at each bolt hole.

Part Number	Description	Price
5-9100	1500 WATTS, 120 VAC	\$6.98
5-9101	1500 WATTS, 240 VAC	\$6.98
5-9102	2000 WATTS, 120 VAC	\$6.98
5-9103	2000 WATTS, 240 VAC	\$6.98
5-9105	3000 WATTS, 240 VAC	\$6.98
5-9106	3500 WATTS, 240 VAC	\$7.49
5-9107	4500 WATTS, 240 VAC	\$7.49
5-9108	5500 WATTS, 240 VAC	\$9.98

Low Watt Density



Part Number	Description	Price
5-9126	4500 WATTS, 240 VAC	\$9.98

Screw-In

High Watt Density



### SCREW-IN ELEMENTS High Watt Density

1-1/2" HEX NUT

Part Number	Description	Price
5-9110	1500 WATTS, 120 VAC	\$6.98
5-9112	2000 WATTS, 120 VAC	\$6.98
5-9114	2500 WATTS, 240 VAC	\$6.98
5-9116	3500 WATTS, 240 VAC	\$7.49
5-9117	4500 WATTS, 240 VAC	\$6.98

Low Watt Density

Part Number	Description	Price
5-9127	3500 WATTS, 240 VAC	\$10.69
5-9128	4500 WATTS, 240 VAC	\$9.98

Lifetime Warranty



### SCREW-IN ELEMENTS Low Watt Density

High grade nickel and stainless steel withstands dry firing heats in lime & sand.

#### LIFETIME WARRANTY

Part Number	Description	Price
5-9116-5	3500 WATTS, 240 VAC	\$17.49

Dry Type

Retaw-Suburban

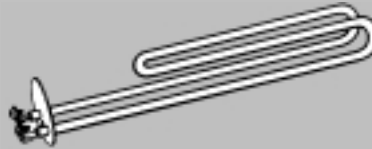

### DRY TYPE ELEMENT FOR RETAW - SUBURBAN

Part Number	Description	Price
5-9130	1500 WATTS, 120 VAC	\$9.98

Speed-O-Matic

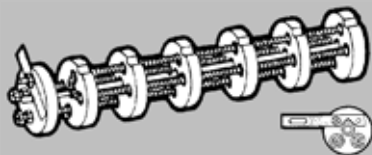

### DRY TYPE ELEMENT FOR SPEED - O - MATIC

Part Number	Description	Price
5-9136	1750 WATTS, 120 VAC	\$13.98
5-9137	2000 WATTS, 240 VAC	\$14.29

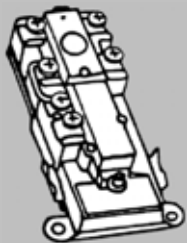

### THERMOSTATS FOR WATER HEATERS

#### COMBINATION THERMOSTAT AND LIMIT CONTROL

Part Number	Description	Price
5-9145	SINGLE POLE	\$15.59
5-9146	DOUBLE POLE	\$16.29

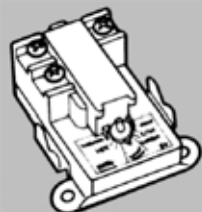

### THERMOSTATS ONLY FOR WATER HEATERS

Part Number	Description	Price
5-9147	SINGLE POLE	\$7.79

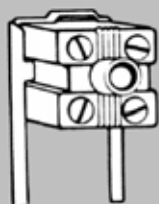

### LIMIT (Manual Reset) FOR WATER HEATER THERMOSTATS

Part Number	Price
5-9149	\$6.98

Extended Shank

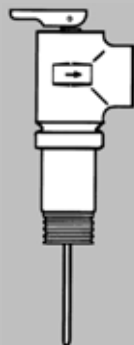

### TEMPERATURE & PRESSURE RELIEF VALVE Brass Body

Has 2-1/2" long extended shank for use where water heaters have thick wall insulation. Probe length 2-1/2". 3/4" M.P.T. inlet, 3/4" F.P.T. outlet. Pressure setting of 150 PSI.

Part Number	Price
5-9076	\$14.98

Standard Length Shank



### TEMPERATURE & PRESSURE RELIEF VALVE Brass Body

Probe length 4"5/8". 3/4" M.P.T. inlet, 3/4" F.P.T. outlet. Pressure setting of 150 PSI.

Part Number	Price
5-9077	\$10.98



### ON-OFF SWITCH FOR WATER HEATERS

SINGLE POLE, SINGLE THROW  
120 VAC, 20 AMP, 1/2 HP  
SNAPS IN PLACE

Part Number	Price
5-9165	\$6.98

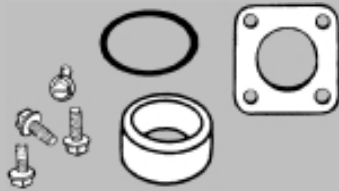

**ELEMENT GASKET KIT**  
**1-GASKET FOR FLAT FLANGE**  
**1-GASKET FOR UNIVERSAL**  
**1-GASKET FOR SCREW-IN**  
**4-SELF TAPPING SCREWS**

**Part Number**  
5-9075

**Price**  
\$2.98

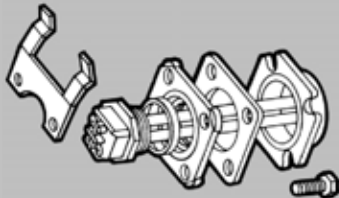

**UNIVERSAL ADAPTER KIT**

Replace round head, flat flange and universal flange with a screw-in element.

**Part Number**  
5-9172

**Price**  
\$6.98

Element Screws

1/4" Diameter



**SCREW**  
**Self-Tapping**  
**Hex Washer Plated Steel**

**1/4" DIA. 3/4" LONG**  
**20 THREADS PER INCH**

**Part Number**  
5-9150

**Price**  
\$0.16

5/16" Diameter



**SCREW**  
**Hex Washer Plated Steel**

**5/16" DIA. 5/8" LONG**  
**18 THREADS PER INCH**

**Part Number**  
5-9151

**Price**  
\$0.35

Screw-In

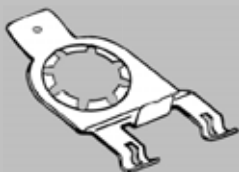

**THERMOSTAT BRACKET**  
**FOR**  
**SCREW-IN ELEMENT**

**Part Number**  
5-9152

**Price**  
\$1.49

Universal



**THERMOSTAT BRACKET**  
**FOR**  
**UNIVERSAL OR FLAT**  
**ELEMENT**

**Part Number**  
5-9153

**Price**  
\$0.79

Round Head



**THERMOSTAT BRACKET**  
**FOR**  
**ROUND HEAD ELEMENT**

**Part Number**  
5-9154

**Price**  
\$0.00

Round Head



**GASKET**  
**FOR**  
**ROUND HEAD ELEMENT**

**Part Number**  
5-9155

**Price**  
\$0.00

Screw-In



**GASKET**  
**FOR**  
**SCREW-IN ELEMENT**

**Part Number**  
5-9156

**Price**  
\$0.44

Molder Round Head



**MOLDED**  
**ROUND HEAD GASKET**

**Part Number**  
5-9161

**Price**  
\$0.00

Universal Flange



**GASKET**  
**FOR**  
**UNIVERSAL FLANGE ELEMENTS**

**Part Number**  
5-9162

**Price**  
\$0.39

Flat Flange

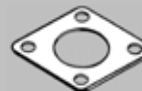

**GASKET**  
**FOR**  
**4-HOLE FLAT FLANGE ELEMENTS**

**Part Number**  
5-9164

**Price**  
\$0.59



### DRAIN VALVE Water Heater

This brass drain valve has a 2-1/2" long shank with 3/4" male pipe threads x 3/4" male garden hose threads.

**Part Number**  
5-9168

**Price**  
\$5.98



### EXTENDER FOR T & P VALVES

Enables short shank T & P valves to be used on water heater that has thick insulated walls. 3" long dielectric construction.

**Part Number**  
5-9078

**Price**  
\$6.98



### NIPPLES DIELECTRIC

For use where dissimilar metals occur in piping & plumbing systems. 3/4" M.P.T. each end. 3" long.

**Part Number**  
5-9079

**Price**  
\$5.98

F.P.T. Nuts Each End

### WATER CONNECTOR FLEXIBLE COPPER

7/8" O.D. corrugated seamless copper tubing. Has 3/4" N.P.T. nut on each end.



Part Number	Description	Price
5-9192	18" LONG	\$9.98
5-9193	24" LONG	\$11.98

F.P.T. Nut x Pex

### WATER CONNECTOR FLEXIBLE COPPER

7/8" O.D. corrugated seamless copper tubing. Has 3/4" N.P.T. nut one end, other end has 3/4" Pex barb.



Part Number	Description	Price
5-9196	18" LONG	\$9.98
5-9197	24" LONG	\$11.98



### ACCESS DOORS FOR WATER HEATER

These doors have a 1-3/16" wide white painted extruded aluminum frame with predrilled holes for mounting to home. Door is made of white cedar embossed aluminum metal that covers a 3/8" thick piece of sheet rock with a white 5/8" wide extruded aluminum frame. Door opens by lifting up and pulling out from the bottom.

Rough opening is 22" wide x 60" high. Overall measurements are 24" wide x 61-1/2" high. Air vent is 16" wide x 14" high.

Part Number	Description	Price
5-9200	WITH VENT	\$89.98
5-9201	NO VENT	\$87.98

Plastic



### PLASTIC PANS FOR WATER HEATERS

Made of Hi-impact styrene. Meets southern building codes. Predrilled for and comes with 1" dia. PVC drain adapter. Pans are 2-1/2" deep. For electric water heaters only.

Part Number	Description	Price
5-9204	20" INSIDE DIAMETER	\$7.19
5-9205	22" INSIDE DIAMETER	\$7.98

Aluminum



### ALUMINUM PANS FOR WATER HEATERS

Made of heavy gauge aluminum, will not rust, corrode or crack. Side opening is predrilled for and supplied with 1" diameter PVC adapter. Pans are 2" deep. For electric or water heaters.

Part Number	Description	Price
5-9208	22" INSIDE DIAMETER	\$19.79
5-9209	24" INSIDE DIAMETER	\$22.09



### ACCESS PANEL Commercial Grade

Made of high impact **white plastic**. Can be painted or wallpapered. May be glued to wall or you may drill out pilot holes and fasten with screws. Access panel snaps into frame assembly. May be installed horizontally or vertically.

Part Number	Overall Length	Opening Size	Price
5-9215	8-1/8" x 11-1/8"	6" x 9"	\$9.98
5-9216	17" x 17"	14" x 14"	\$17.98

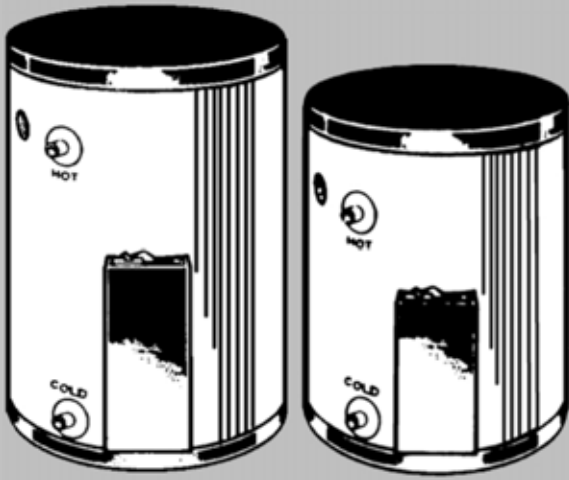

**ELECTRIC WATER HEATERS**  
by  
**American Water Heater Company**

**GLASS LINED TANK** ... tank surface is coated with an exclusive blue cobalt ceramic formula and fused to the solid steel shell at 1600 degree's F. Tank is designed and tested to withstand 300 PSI hydrostatic test pressure and working pressure of 150 PSI A.S.N.I. Z21.10.1 1975 standard.

**HOT WATER OUTLET-COLD WATER INLET, RELIEF VALVE OPENING** ... side mounted water connections allow fast, economical installations.

**INSULATION** ... of non-cfc Styrofoam to provide greater heat retention, improved energy savings.

**AUTOMATIC TEMPERATURE CONTROL** ... surface mounted thermostat automatically keeps the water temperature at the desired temperature.

**OVER TEMPERATURE PROTECTOR** ... automatically and safely cuts off the power in the unlikely event the preset temperature is exceeded.

**ANODE ROD** ... top mounted, heavy duty anode rod for added tank protection, extending the life of the tank.

**T&P VALVE** ... all water heaters come with a side mounted temperature & pressure valve factory installed.

Part Number	Gallon Capacity	Watts	Number of Elements	Volt AC Only	Water Heater Height	Diameter	Price
5-9510	19	1500	SINGLE	120	24-7/8"	18"	\$279.00
5-9511	28	4500	DOUBLE	240	29-1/2"	22"	\$285.00
5-9516	30	4500	DOUBLE	240	46"	18"	\$286.00
5-9517	40	4500	DOUBLE	240	48"	20"	\$295.00

**WARRANTY:** All component parts and tank has a 6-year non-prorated limited warranty, providing the heaters are not used in a commercial application.

**\*\*\*\* THERE IS A WHITE GOODS DISPOSAL TAX ON ALL WATER HEATERS \*\*\*\***